

Lined Piping Systems - Tee

Lined Tee

Construction : Smoothbore
Pipe : Carbon Steel / Stainless Steel (Other specialty metals on request)
Liner: PTFE, PFA, PVDF, PP, FEP, ETFE
Size Available : 1" - 12" (Larger sizes upon Request)
Vacuum : Full Vacuum
Temperature : -30°C to 260°C

	Low Med High
Flexibility	
Cycle Life	
Pressure Rating	
Chemical Resistance	
Wall Thickness	

Construction

Use:
 Our range of products are used in various industries such as Chemicals, Refineries, Pesticides, Petrochemicals, Steel, Food-Processing, Beverages, Alcohols and Acids, Pharmaceuticals, Circuit Breakers, Fertilizers, Desalination.



Standards:

ASTM F1545, AS4041:2006 Class 1, ASME IX:2010

Specifications

Part Number:	Size		Face to Centre (X)
	NB1	NB2	mm
TLPTa-25-25-AF3-AF3-b	1"	1"	89
TLPTa-38-38-25-AF3-AF3-b	1 1/2"	1"	102
TLPTa-38-38-AF3-AF3-b	1 1/2"	1 1/2"	102
TLPTa-50-50-AF3-AF3-b	2"	1"	114
TLPTa-50-50-38-AF3-AF3-b	2"	1 1/2"	114
TLPTa-50-50-AF3-AF3-b	2"	2"	114
TLPTa-80-80-38-AF3-AF3-b	3"	1 1/2"	140
TLPTa-80-80-50-AF3-AF3-b	3"	2"	140
TLPTa-80-80-AF3-AF3-b	3"	3"	140
TLPTa-100-100-50-AF3-AF3-b	4"	2"	165
TLPTa-100-100-80-AF3-AF3-b	4"	3"	165
TLPTa-100-100-AF3-AF3-b	4"	4"	165
TLPTa-150-150-80-AF3-AF3-b	6"	3"	203
TLPTa-150-150-100-AF3-AF3-b	6"	4"	203
TLPTa-150-150-AF3-AF3-b	6"	6"	203
TLPTa-200-200-AF3-AF3-b	8"	8"	229

At temp(°C)	ANSI class 150	ANSI class 300
°C	kpa	kpa
40	1760	3160
100	1650	2740
150	1510	2430
200	1400	2080
250	1200	1720

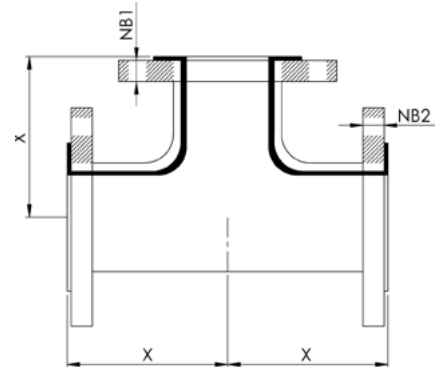

Part Number Key:

a = Pipe Material: 6S = 316 Stainless Steel | 4S = 304 Stainless Steel | MS = Carbon Steel
b = 316 Stainless Steel Flange Type: A1 = ANSI 150lb | TE = Table E | TD = Table D | D16 = DIN 16

Applications

