

PTFE Expansion Joint 3 - Convoluted (PEJ3)

PTFE Expansion Joint - PEJ3

Part No.: PEJ3

Construction: Convoluted

Profile: High Flexibility / Medium Pressure

Liner: Optional

Size Available: 1" - 8"
(Larger sizes upon Request)

Temperature: 10°C +204°C

Low | Med | High

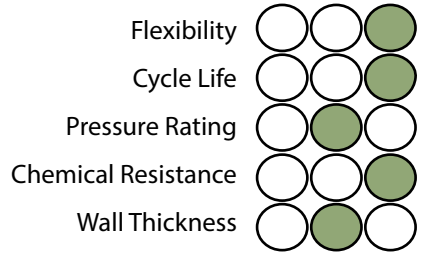

Construction

Use:

PTFE bellows are specifically designed to compensate for pipe expansion, vibration and misalignment in process piping and vessels. PTFE bellows are constructed from uniform-walled isostatically molded PTFE and demonstrate a high level of design consistency throughout the product line.

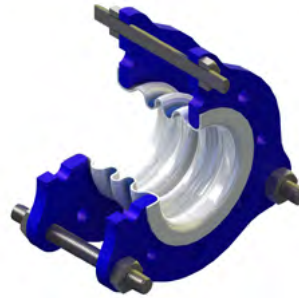

Specifications

Part Number	Nom Bore (mm)	Length (mm)	Flare Diameter (mm)	Max. Working Pressure (10°C) kPa	Movements		Weight kg
					± Maximum Travel (mm)	Maximum Misalignment (mm)	
PEJ-25-3	25	46	50	1034	12	6	1.22
PEJ-38-3	38	51	73	1034	12	6	1.85
PEJ-50-3	50	70	92	1034	20	10	3.67
PEJ-65-3	65	76	104	1034	25	10	5.08
PEJ-80-3	80	93	127	1034	25	12	6.16
PEJ-100-3	102	95	157	1034	28	12	8.57
PEJ-125-3	125	100	185	1034	28	12	10.61
PEJ-150-3	150	102	216	1034	28	4	13.19
PEJ-200-3	200	138	269	965	42	4	19.50

*See Operating Pressure vs. Temperature graph for correction factors. Page 91

Applications

