

WELDING NECK

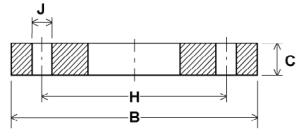
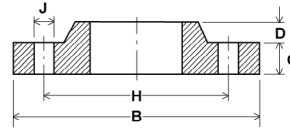
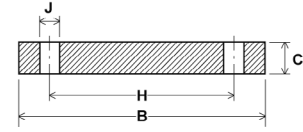

PLATE SLIP-ON WELDING



BOSSED



BLANK

TABLE D

| Nominal Pipe Size | | Outside Diameter of Pipe | Flange Outside Diameter | Thickness of Flange | | Length Through Hub | | Diameter at Large End of Neck | Diameter at Small End of Neck | Drilling Data | | |
|-------------------|--------|--------------------------|-------------------------|---------------------|-----------------|--------------------|------------------------|-------------------------------|-------------------------------|----------------------|------------------------|-----------------|
| | | | | Copper Alloy | Plate or Forged | Length of Boss | Length of Welding Neck | | | Bolt Circle Diameter | Diameter of Bolt Holes | Number of Bolts |
| mm | inch | A | B | C | C | D | E | F | G | H | J | K |
| 15 | 1/2" | 21.3 | 95 | 6 | 5 | 10 | 22 | 27 | 22 | 67 | 14 | 4 |
| 20 | 3/4" | 26.7 | 100 | 6 | 5 | 11 | 22 | 33 | 27 | 73 | 14 | 4 |
| 25 | 1" | 33.4 | 115 | 8 | 5 | 11 | 22 | 43 | 34 | 83 | 14 | 4 |
| 32 | 1 1/4" | 42.2 | 120 | 8 | 6 | 11 | 26 | 49 | 43 | 87 | 14 | 4 |
| 40 | 1 1/2" | 48.3 | 135 | 10 | 6 | 13 | 29 | 59 | 49 | 98 | 14 | 4 |
| 50 | 2" | 60.3 | 150 | 10 | 8 | 13 | 29 | 70 | 61 | 114 | 19 | 4 |
| 65 | 2 1/2" | 73 | 165 | 11 | 8 | 16 | 32 | 83 | 76 | 127 | 19 | 4 |
| 80 | 3" | 88.9 | 185 | 13 | 10 | 16 | 35 | 102 | 89 | 146 | 19 | 4 |
| 100 | 4" | 114.3 | 215 | 16 | 10 | 19 | 41 | 130 | 115 | 178 | 19 | 4 |
| 125 | 5" | 141.3 | 255 | 17 | 13 | 19 | 44 | 152 | 142 | 210 | 19 | 8 |
| 150 | 6" | 168.3 | 280 | 17 | 13 | 19 | 48 | 187 | 169 | 235 | 19 | 8 |
| 200 | 8" | 219.1 | 335 | 19 | 13 | 22 | 51 | 241 | 220 | 292 | 19 | 8 |
| 250 | 10" | 273.8 | 405 | 19 | 16 | 27 | 64 | 292 | 274 | 356 | 22 | 8 |
| 300 | 12" | 323.8 | 455 | 22 | 19 | 29 | 70 | 343 | 324 | 406 | 22 | 12 |
| 350 | 14" | 355.6 | 525 | 25 | 22 | - | 73 | 387 | 356 | 470 | 26 | 12 |
| 400 | 16" | 406.4 | 580 | 25 | 22 | - | - | - | - | 521 | 26 | 12 |
| 450 | 18" | 457 | 640 | 29 | 25 | - | - | - | - | 584 | 26 | 12 |
| 500 | 20" | 508 | 705 | 32 | 29 | - | - | - | - | 641 | 26 | 16 |
| 600 | 24" | 610 | 825 | 35 | 32 | - | - | - | - | 756 | 30 | 16 |

Note:

- Dimensions are in (mm)
- Larger sizes available on request
- Thickness dimension include raised face
- Available with or without raised face
- Pipe diameter to ANSI standard
- Bore to suit customers pipe